



## The Cleave

Harpenden, AL5 5SJ

Extremely well presented three bedroom, end of terrace home of circa 958 sq ft in a popular cul-de-sac. Private garden with gated access to the rear and driveway with off-street parking. Within walking distance of the town centre and station and well placed for excellent schooling.

**Guide price £600,000**

# The Cleave

Harpenden, AL5 5SJ



- End-terrace home
- Private garden with gated rear access
- Walking distance of town centre & station
- Three bedrooms
- Driveway
- Well placed for excellent schooling
- Circa 961 sq ft
- Popular cul-de-sac
- Council Tax Band D

## Entrance Hall

## Kitchen

10'5" x 6'7" (3.20 x 2.03)

## Living/Dining Room

18'0" x 16'0" (5.49 x 4.88 )

## Utility Room

8'9" x 7'3" (2.67 x 2.23 )

## Store

7'3" x 5'0" (2.23 x 1.54)

## Landing

## Bedroom One

15'10" x 8'11" (4.83 x 2.74)

## Bedroom Two

10'0" x 9'6" (3.05 x 2.90)

## Bedroom Three

10'5" x 8'0" (3.20 x 2.44)

## Bathroom

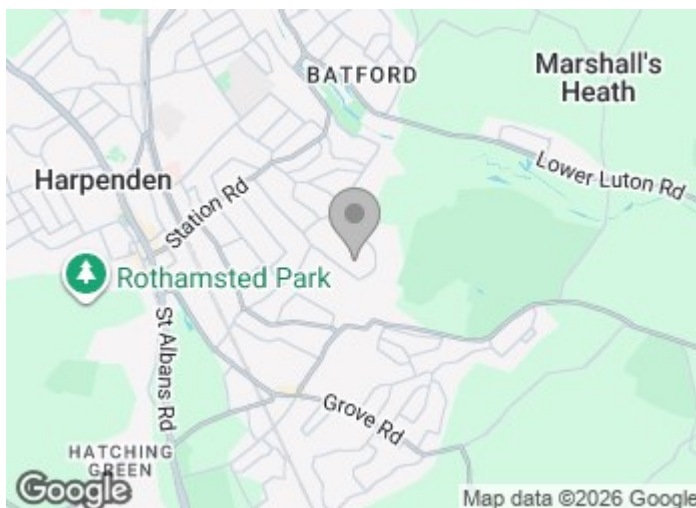



# Floor Plan

## Ground Floor

Approx. 47.1 sq. metres (507.1 sq. feet)

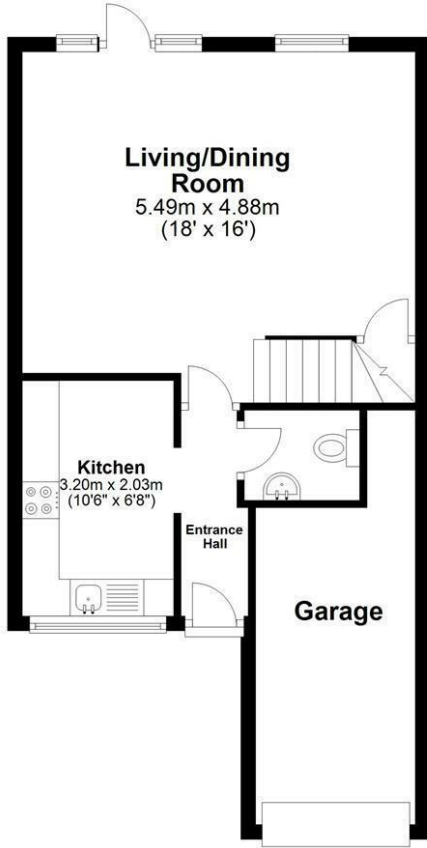

## First Floor

Approx. 41.9 sq. metres (450.9 sq. feet)

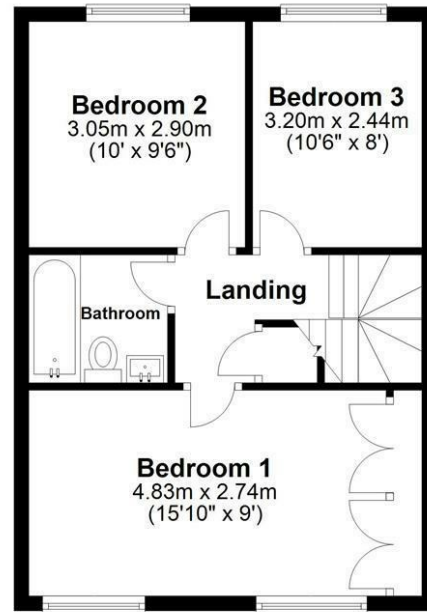

Total area: approx. 89.0 sq. metres (958.0 sq. feet)

Sketch layout only. Not to scale. Plan produced for Whittaker & Co.

Plan produced using PlanUp.

These particulars, whilst believed to be accurate are set out as a general outline only for guidance and do not constitute any part of an offer or contract. Intending purchasers should not rely on them as statements of representation of fact, but must satisfy themselves by inspection or otherwise as to their accuracy. No person in this firm's employment has the authority to make or give any representation or warranty in respect of the property.

